

SH304933 Clearance Gauge for John Deere STS Combines

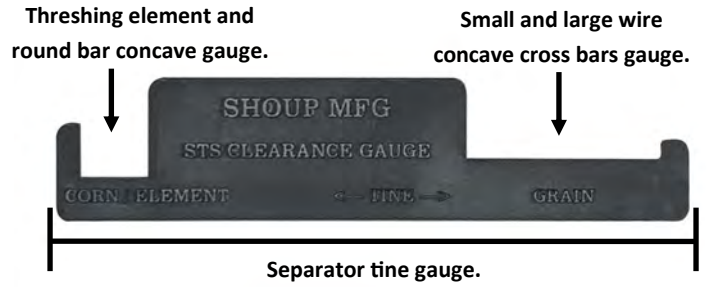

Replace:

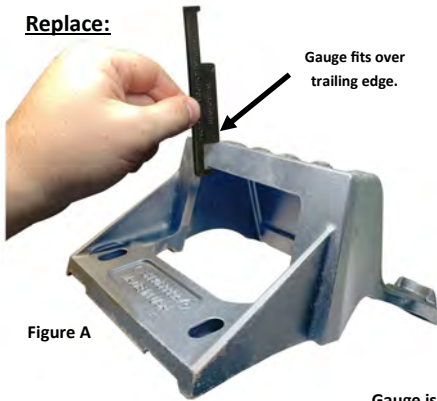

Figure A

When the trailing edge of threshing element fits into "Corn/Element" side of gauge, as seen in **Figure A**, the threshing element is worn and should be replaced.

Figure B doesn't need to be replaced.

Acceptable:

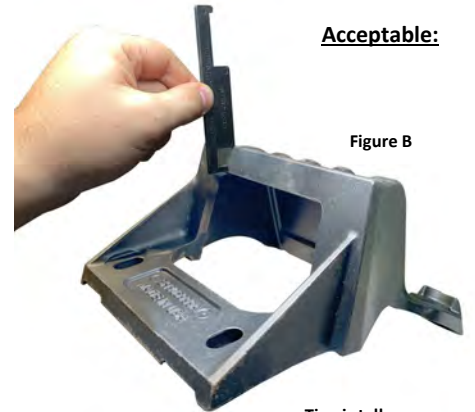

Figure B

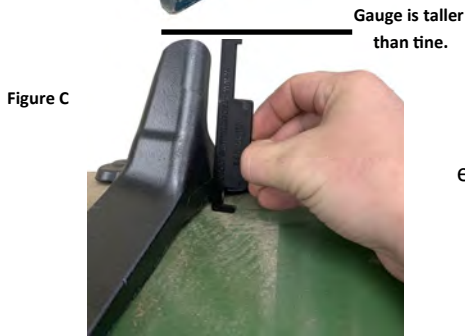

Figure C

When checking separator tines place one end of gauge flush to rotor. If the tine is shorter than the plastic gauge, as seen in **Figure C**, separator tine should be replaced.

Figure D doesn't need to be replaced.

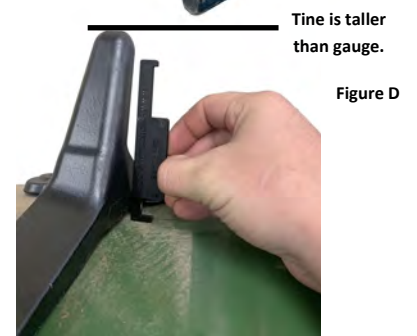

Figure D

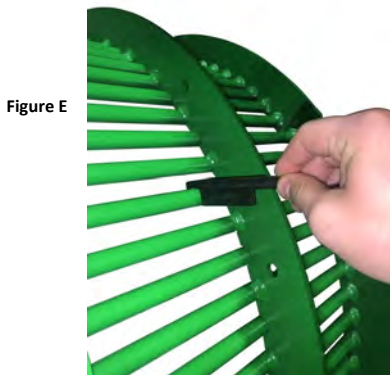

Figure E

When the "corn/element" side of gauge can fit over any of the round bars in the concave, as seen in **Figure E**, the concave should be replaced.

Figure F doesn't need to be replaced.



Figure F



Figure G

When the "grain" side of the gauge can fit over any cross bars on small/large wire concave, as seen if **Figure G**, the concave should be replaced.

Figure H doesn't need to be replaced.

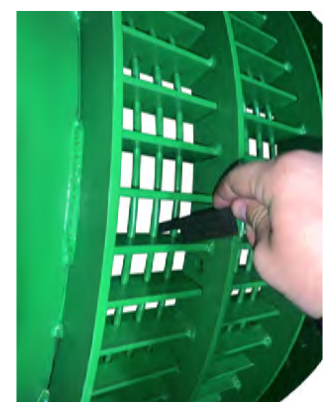

Figure H