



Flange Bushing Rebuild

Installation Instructions

Arm Kit

CIH/New Holland

PRE-INSTALLATION PREPARATION

1. Sort and lay out packaged components by part number. Each bag should be labeled with S.I. Distributing's part number which is helpful for reference.
 - The diagrams within these instructions will be used to reference to understand the placement of the various bolts you have in your kit.
2. Check each row for clearance issues with either the bolt and/or hex bushing.
 - If you have any of the following call S.I. Distributing for alternative solutions.
 - A location that may not allow fitment of either the bolt or hex bushing.
 - Row unit has attachments to support plate (row cleaner mount, down pressure spring bracket) inhibiting the use of either the bolt or hex bushing.
 - Any clearance issue that inhibits the installation or functionality of these kits.

SAFETY REMINDER

Always wear proper safety equipment when using power tools.

SAFETY GLASSES, HEARING PROTECTION, AND GLOVES ARE A MUST WHEN WORKING WITH REAMERS AND METAL SHAVINGS!



PARALLEL ARM INSTALLATION

1. Check to make sure you have the correct bolts for each of the hole locations.
 - Some planters will use 4 carriage bolts for the upper arms, some will use 2 carriage bolts and 2 hex bolts. Both are included in this kit.
 2. Make sure carriage bolt shoulder does not protrude outside of the hole.
 - If the shoulder is too long a washer can be placed under bolt head to shim the shoulder back. The hex bushings **must not** contact the bolt shoulder.
 3. Install the bolts through the row unit/support plate holes then through the flange bushings in the parallel arms.
 4. Place red thread locker starting ½” from the end of the bolt.
 5. Using included spacer washers, shim hex bushing to fill some of the gap between the hex bushing head and flange bushing.
 - Using diagram below:
 - Location A: use one HDW012610 1/8” shim washer
 - Location B: use one HDW012610 1/8” shim washer
 - Location C: use one HDW012610 1/8” shim washer
 - Location D: use one HDW012610 1/8” shim washer
 - Washers must turn by hand when the hex bushings are tight.
 - If extra gap on the hex busing is present one HDW010890 1/16” shim washer can be added.
- Again, the washers must spin when torqued to specifications.



6. Tighten hex bushing to torque value of 80 ft. lbs.
7. Apply one drop of red thread locker to end of bolt threads.
8. Install jam nut, torque to value of 65 ft. lbs jam nut installation, apply one drop of red thread locker, thread on by hand then torque to 45 ft. lbs.

FINAL CHECK

1. Spray each hex bushing on top and bottom with small amount of penetrating spray.
2. Make sure row unit moves freely.

Installation Diagram

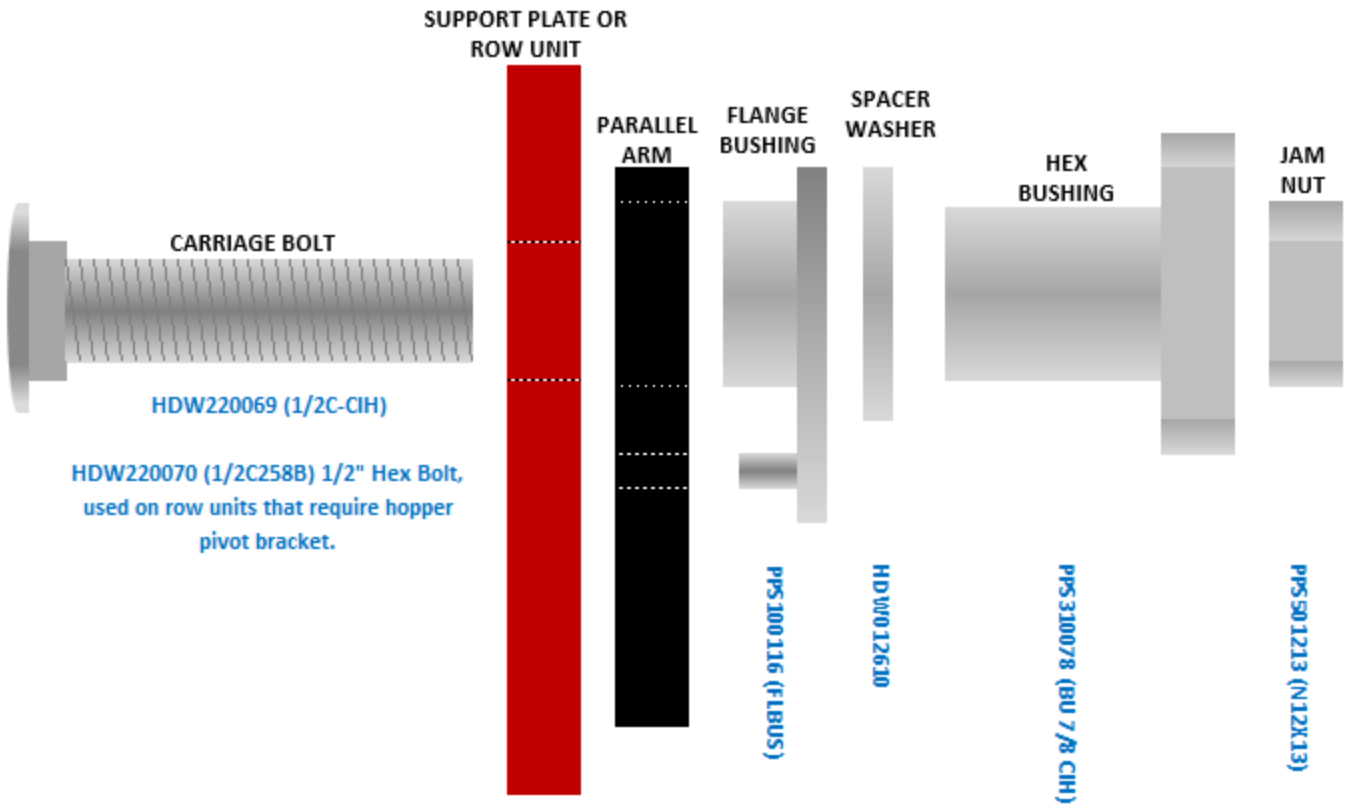



S.I. DISTRIBUTING

13540 Spencerville Road • Spencerville, Ohio 45887

Phone: 800-368-7773 • 419-647-4909

Fax: 877-398-8074 • 419-647-6290

www.sidist.com • info@sidist.com