



360 BANDIT™

INSTALLATION INSTRUCTIONS
KINZE 3000 MODELS



360YIELDCENTER.COM

FOR QUESTIONS PLEASE CONTACT OUR
PRODUCT SUPPORT TEAM AT 309-300-3120

4.11.23 • V10

All trademarks are the property of 360 Yield Center, its affiliates and/or its licensors. ©2019 360 Yield Center. All rights reserved.



INSTALLATION INSTRUCTIONS

KINZE 3000



BEFORE YOU BEGIN...

HELPFUL TOOLS



Hammer/Mallet

Wrench Sizes: 3/4", 9/16" and 15/16"

Socket Sizes: 3/4", 9/16" and 15/16"

Impact Driver/ Socket Wrench

STEP 1

REMOVE CLOSING WHEELS

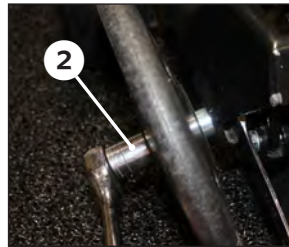
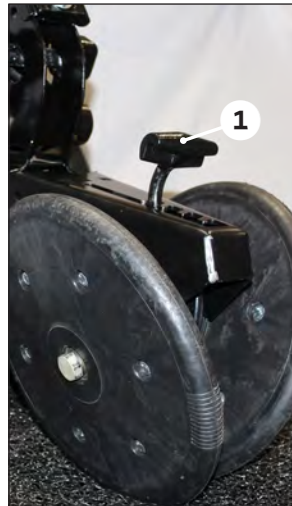

Release spring **1** to remove tension from closing system.

Remove closing wheels with a 15/16" socket and wrench **2**. Retain the closing wheels, bolts, and nuts for re-installation later in the instructions.

If present, remove insecticide attachment.

NOTES:

Removal of the closing wheels is necessary to facilitate the ease of removing and reinstalling the spring.

If you are installing the optional chains kit, the bolts and nuts **3 can be discarded but the bushings **4** need to be kept.**

STEP 2

REMOVE CLOSING SYSTEM ARMS

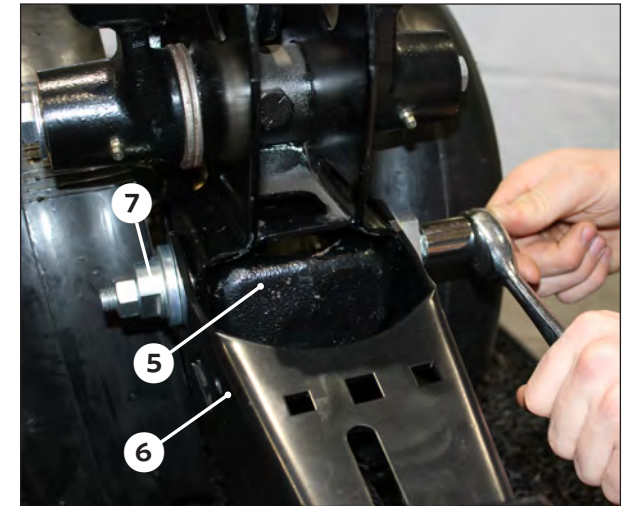

Using a 9/16" socket, remove the bolt that holds the closing wheel arm stop **5** to the row unit between the gauge wheels.

NOTE: The gauge wheels may need to be held up to remove the bolt.

Using a 3/4" socket remove the nut from the carriage bolt that secures the closing system arms on the row unit.

Remove carriage bolt and remove closing system arms **6** from the row unit. Discard carriage bolt, nut and washers. Retain two piece bushing **7**.

Remove spring from closing wheel arm stop and set closing wheel arm stop to the side.

NOTE: Retain closing wheel arm stop in a safe location for installation of closing system without 360 BANDIT.

INSTALLATION INSTRUCTIONS

KINZE 3000



STEP 3

INSTALL ROCK GUARD

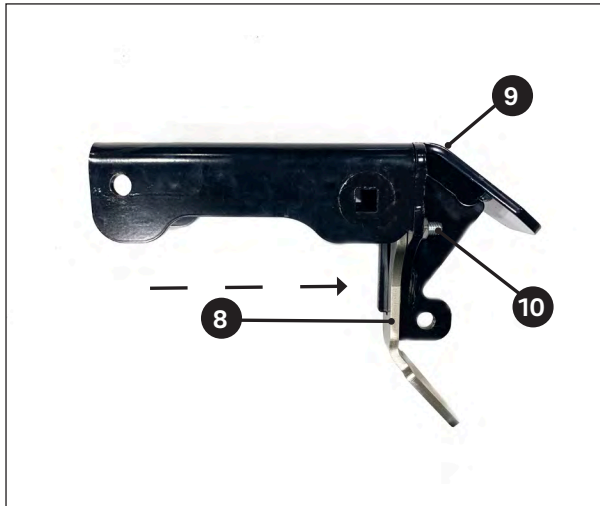

Attach the rock guard **8** to the underside of the extension bracket **9** using two bolts **10**. Secure with nut.

STEP 4

INSTALL BANDIT ARM ASSEMBLY

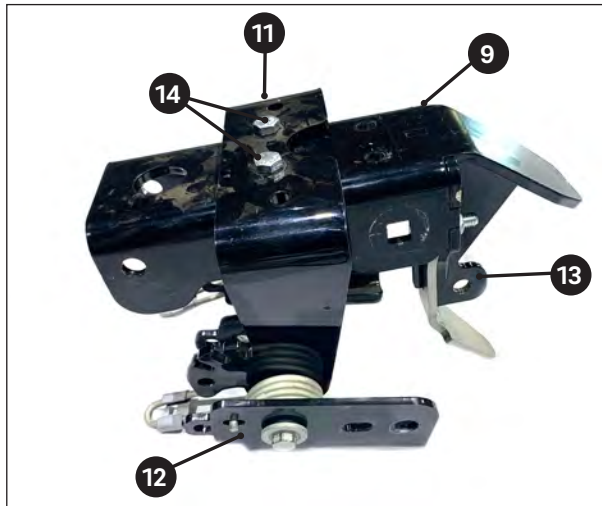

Slide the BANDIT arm assembly **11** over the extension bracket **9**, ensuring BANDIT arms **12** are facing in the rearward direction, towards the spring hook **13**.

Secure arm assembly to the front holes **14** on the extension bracket with (2) 3/8" X 1-1/2" bolts and 3/8" flange nuts.

Tighten with 9/16" socket and wrench.

STEP 5

INSTALL EXTENSION BRACKET



Align holes in extension bracket with the holes on the row unit **15**. Install flat washer on the 1/2" x 1-1/2" bolt from hardware kit #540615. Slide bolt through extension bracket and row unit hole (bolt head on the outside). Install another washer and hand tighten with nyloc nut from hardware kit #540615. Do not tighten.

NOTE: Leave nyloc nuts loose on both sides until after the support strap is installed in STEP 5.

Repeat for other side.

INSTALLATION INSTRUCTIONS

KINZE 3000



STEP 6

INSTALL SUPPORT STRAP

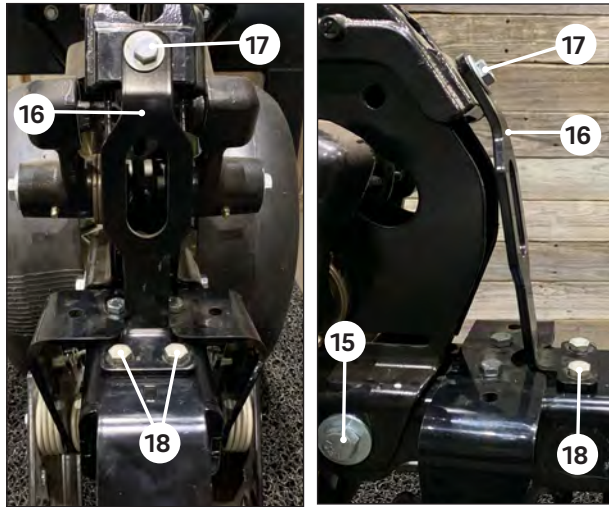

Remove the bolt on the bottom of the depth adjustment assembly and discard.

Secure the top of the support strap ¹⁶ to the depth adjustment assembly using the supplied 3/8" x 1-1/4" bolt and washer from hardware kit #540615 ¹⁷. Ensure all bracketry is flush when bolt is installed.

Attach the support strap to the back holes on the extension bracket with (2) 3/8" x 1-1/4" bolts and 3/8" flange nuts from hardware kit #540615 ¹⁸. Tighten bolts with 9/16" socket and wrench.

NOTE: The extension bracket may need lifted up to align bolt holes. Tighten the bolt down until there is a flat connection between the support strap and the depth adjustment assembly.

Tighten the nyloc nuts that were left loose in STEP 5 with 3/4" socket and wrench securing the BANDIT extension bracket to the row unit ¹⁵.

STEP 7

REINSTALL CLOSING SYSTEM

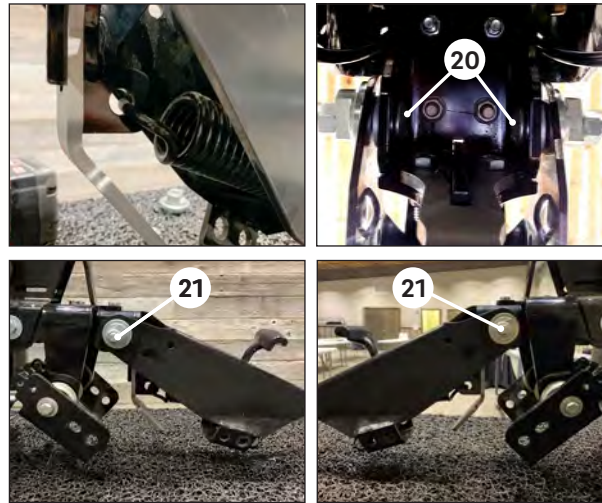

Attach the tensioning spring on the closing system to the spring hook on the BANDIT extension bracket ¹⁹.

Align square holes in extension bracket with holes in closing system arms. From the inside to the outside, using the thick spacer washer (one per side), slide supplied 2-1/4" carriage bolt through all parts (carriage bolt head on the inside) ²⁰. Secure all parts with the previously set aside two-piece bushing and provided 1/2" nyloc nut ²¹. Tighten with 1/2" socket. Adjust bushings according to OEM specs.

STEP 8

PREPARE HOSE GUIDES

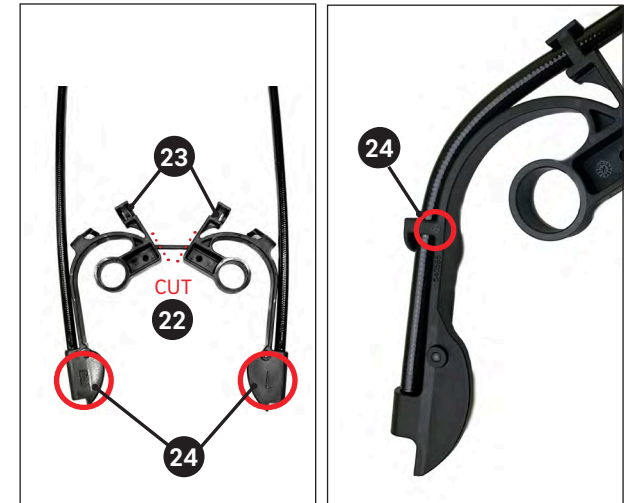

Using side-cutters, cut the two hose guides apart ²².

Ensure the hose is routed through the top two holes in the hose guide ²³.

Hose guides are labeled "L" left and "R" right. Location of the "L" and "R" marking may vary - see pictures above for an example of each possible marking location ²⁴.

NOTE: When installing hose guides on the row unit, left and right are determined from the operators seat.

INSTALLATION INSTRUCTIONS

KINZE 3000



STEP 9

INSTALL DISK ASSEMBLY

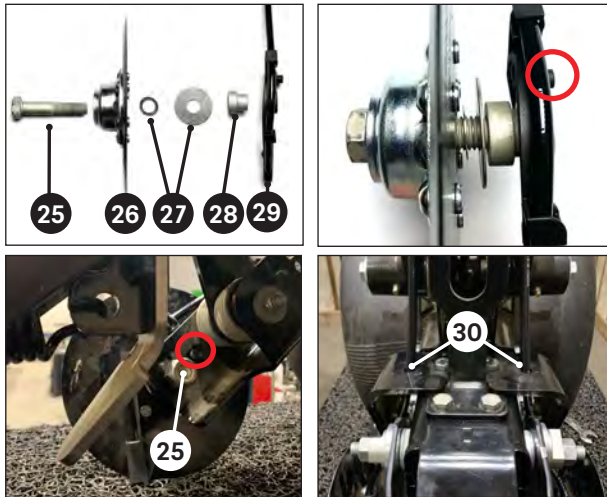

NOTE: Provided dust caps are matched with the hubs with which they are packaged. Keep each packaged kit together.

Insert 5/8" X 3" bolt **25** through the disk **26**. Place small shim washer then fender washer **27** over the bolt. Insert bushing **28** (large side first) and hose guide assembly **29** (ear tab facing in).

Slide bolt of the disk assembly into the lower hole on the bandit **25**, aligning the ear tab with corresponding upper hole and secure with lock nut.

Tighten with 15/16" socket and wrench. Check to ensure that the disk freely turns. If the disk does not freely turn, back off the lock nut slightly until the disk freely turns.

Route application hose through hole in top of 360 BANDIT frame **30**.

Apply silicone to dust cap. Using a mallet, install dust caps over disk bolt heads.

STEP 10

ASSEMBLE PLUMBING

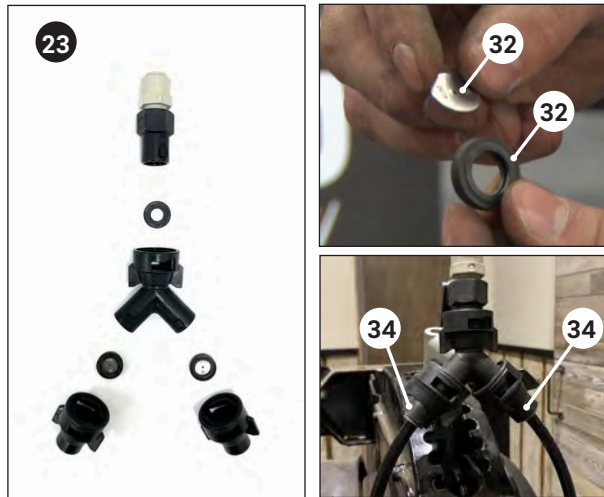

Install orifice plates **31** in the rubber grommets **32**.

Assemble plumbing components in the arrangement shown above **33**.

Attach the plumbing assembly to each of the hoses coming from the house guides **34**.

NOTE: If hoses are not fully seated in the push to connect, they will leak. Hoses seat 7/8" of an inch deep or until you hear a snap.

The supplied push to connect adapter in the 360 BANDIT kit connects to 3/8" push to connect compatible hose.

Secure hoses to row unit with provided zip ties.

INSTALLATION COMPLETE



Using 15/16" socket and wrench, reinstall closing wheels.

NOTE: If the optional Chain Kit is being installed, do not reinstall the closing wheels.

PLUMBING RECOMMENDATIONS:

To prevent excess fertilizer from dribbling out of the hoses when product application is shut off, install one push to connect polypropylene (Inlet x Outlet) 3/8" O.D. check valve (not included) in the plumbing to each row prior to the 360 BANDIT orifices. Check valve is available at Dultmeier Sales (Item #BUCV1103-P38).

A 50 mesh strainer (not included) can be used in the complete plumbing system between tanks and 360 BANDIT to help prevent debris from blocking orifices.

